

Installation Manual

VW PASSAT EST
VW-PASS-E-D



COMPONENTS INCLUDED

SHADES

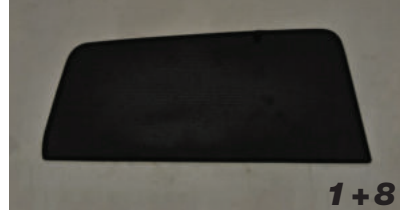
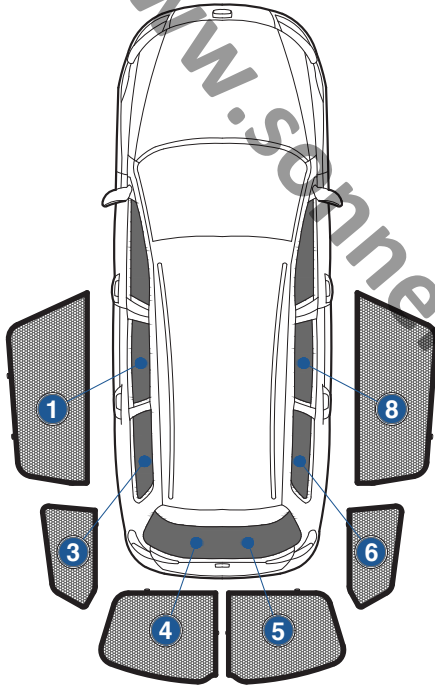

FIXING CLIPS



CL-M12 x 2



CL-M05 x 4



CL-M14 x 1



CL-T01 x 1

Side Shade Installation

VW PASSAT EST
VW-PASS-E-D

COMPONENTS NEEDED:



STEP #1

INSERT CLIPS INSIDE WEATHERSTRIP



STEP #2

POSITION THE SIDE SHADE

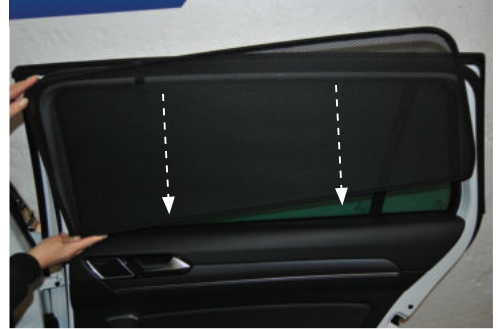

STEP #3

ATTACH SIDE SHADE BEHIND CLIPS

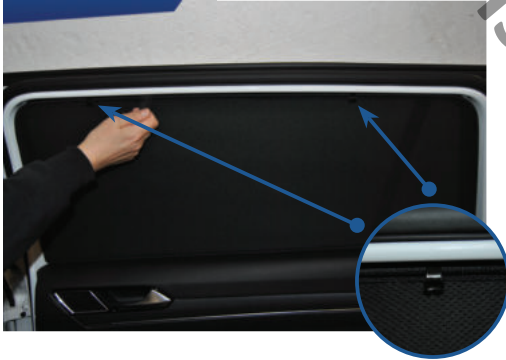

STEP #4

ENSURE SECURELY FITTED IN PLACE

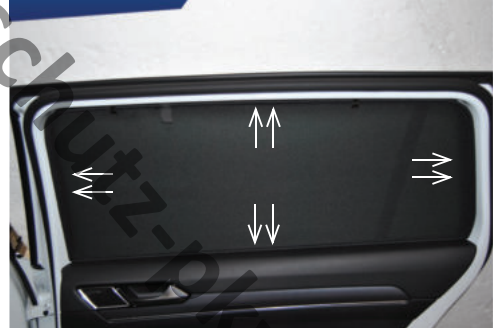

CAR
SHADES

Quarter Light Shade Installation

VW PASSAT EST
VW-PASS-E-D

COMPONENTS NEEDED:



STEP #1

POSITION THE SIDE SHADE



STEP #2

ENSURE SECURELY FITTED IN PLACE

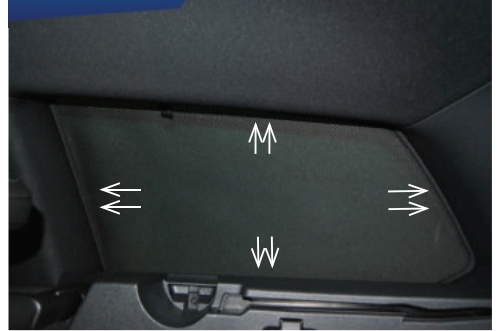

www.sonnenschutz-pkw.de



Rear Shade Installation

VW PASSAT EST
VW-PASS-E-D

COMPONENTS NEEDED:



STEP #1 ATTACH CLIPS ON SHADE EDGES



STEP #2 POSITION THE REAR SHADE

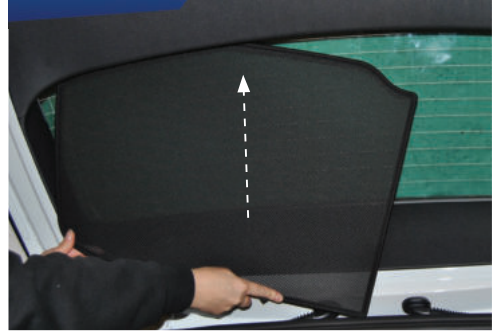

STEP #3 INSERT CLIPS BEHIND INTERIOR TRIM



STEP #4 REPEAT THE PROCESS ON OTHER SHADE



STEP #5 ENSURE SECURELY FITTED IN PLACE

